

Please visit our YouTube channel for all the [set up videos](http://www.youtube.com/user/wheelstandpro) at: <http://www.youtube.com/user/wheelstandpro> or scan the QR code

Place your pedals on the base of the stand and drive 4 conical screws (M5x60) with 4 threaded bushings M5x10 with hands only to fix it firmly.

**HONEYCOMB
pedals
set up video**

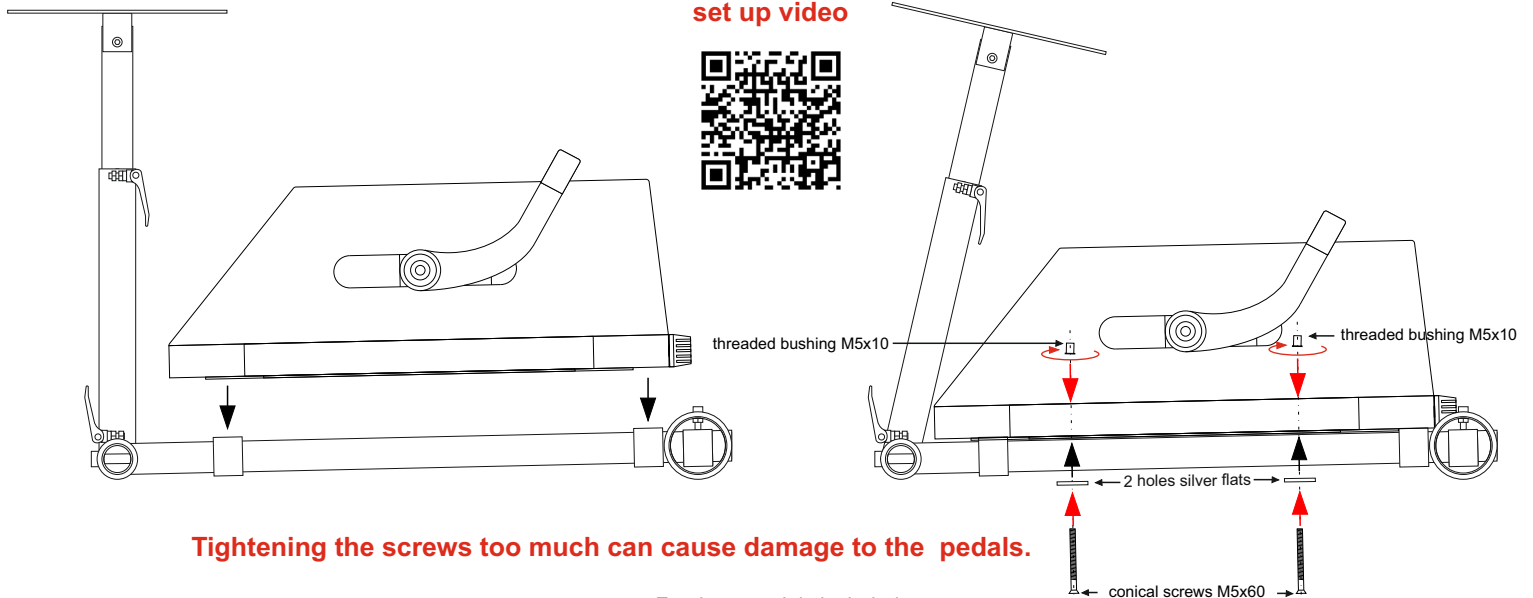

Tightening the screws too much can cause damage to the pedals.

For these pedals included:

4 conical screws (M5x60), 4 threaded bushings (M5x10), 2 silver pedal flats

For details please visit our website
www.wheelstandpro.us

Please visit our YouTube channel for all the [set up videos](http://www.youtube.com/user/wheelstandpro) at: <http://www.youtube.com/user/wheelstandpro> or scan the QR code

Place your pedals on the base of the stand and drive 4 conical screws (M5x60) with 4 threaded bushings M5x10 with hands only to fix it firmly.

**HONEYCOMB
pedals
set up video**

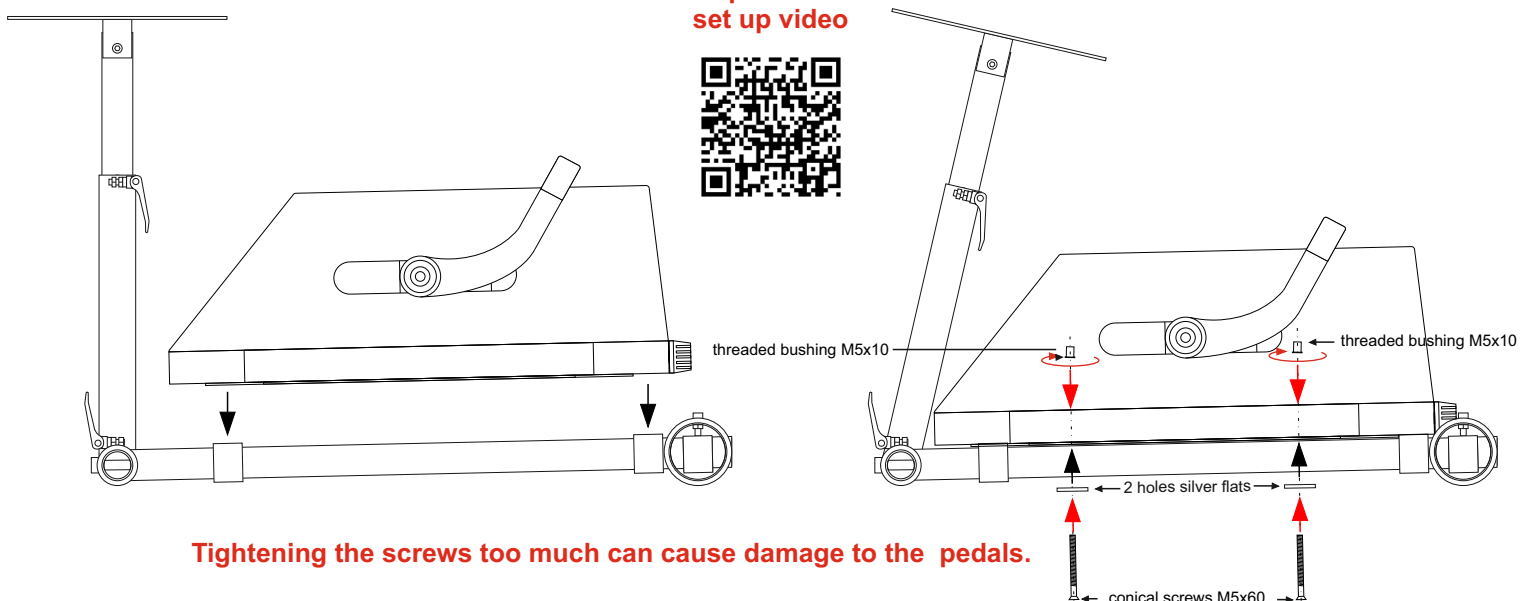

Tightening the screws too much can cause damage to the pedals.

For these pedals included:

4 conical screws (M5x60), 4 threaded bushings (M5x10), 2 silver pedal flats

For details please visit our website
www.wheelstandpro.us