



Please visit our YouTube channel for all the **set up videos** at: <http://www.youtube.com/user/wheelstandpro>

2014 CSP pedals set up video



wheel and shifter set up video



Place your wheel on the main plate and drive 4x Allen screws (M6x16) to fix it firmly.

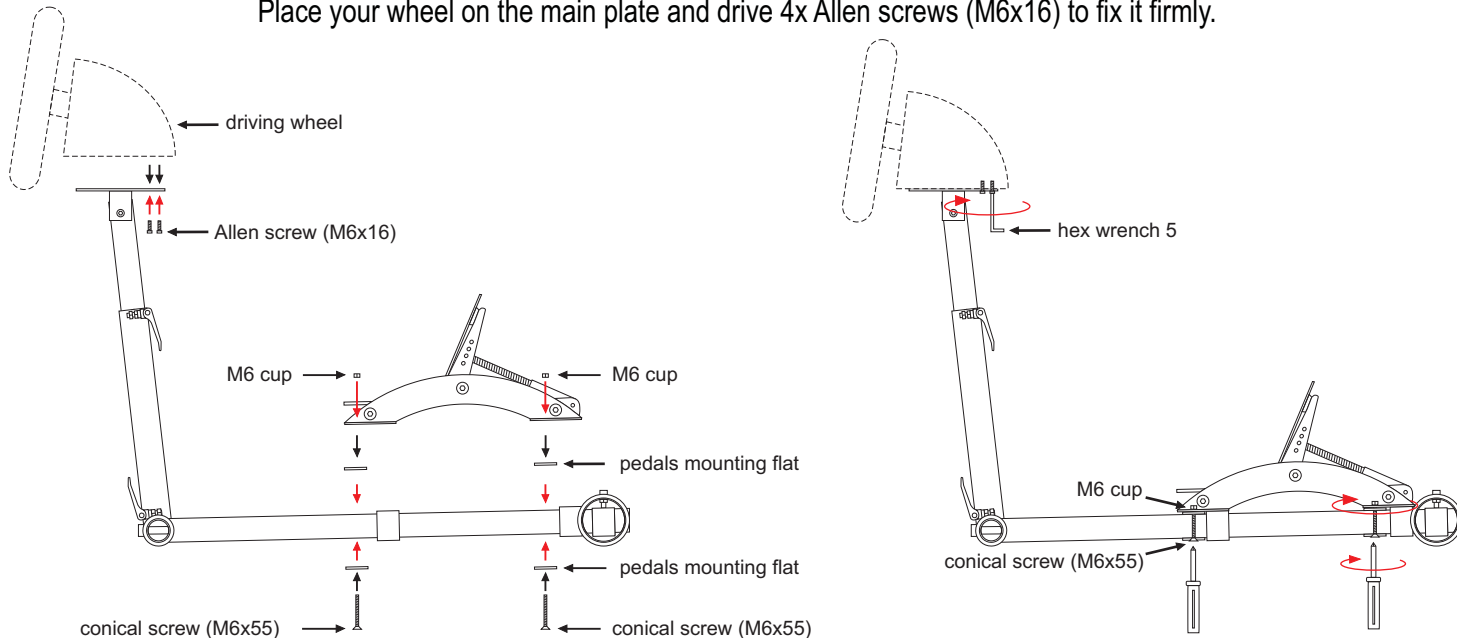

Place your pedals on the stand and drive 4x conical screws M6x55, 4x M6 cups and fix it firmly with 4x pedals flat plates.

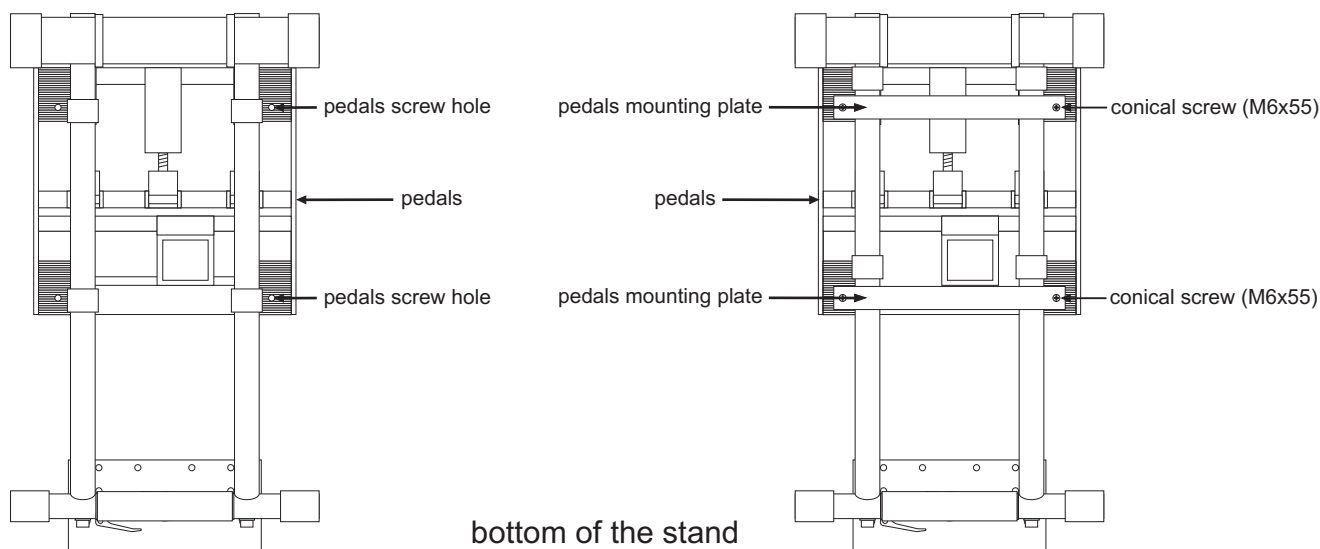

PLEASE ALSO SEE OUR CONSTRUCTOR'S TIPS: <http://www.wheelstandpro.com/contips.html>

Tightening the screws too firmly can cause damage to the wheel and pedals.

For details please visit our website:
www.wheelstandpro.com

